

Sonobe Origami Units

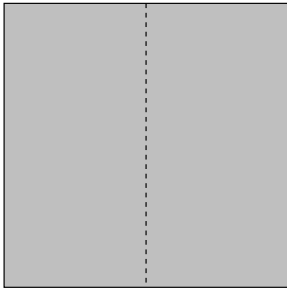

Crease paper down the middle and unfold

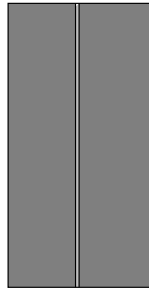

Fold edges to center line and unfold

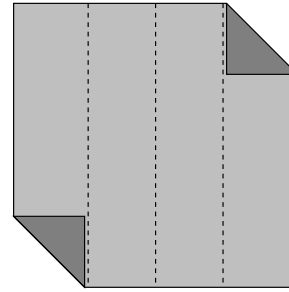

Fold top right and bottom left corners — do not let the triangles cross crease lines

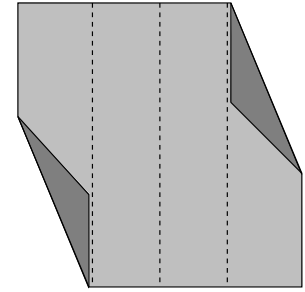

Fold triangles down to make sharper triangles — do not cross the crease lines

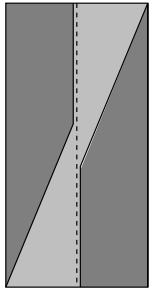

Fold along vertical crease lines

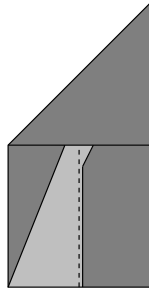

Fold top left corner down to right edge

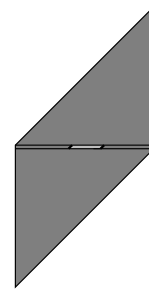

Fold bottom right corner up to left edge

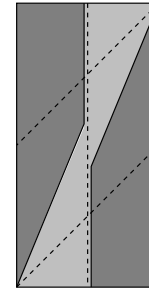

Undo the last two folds

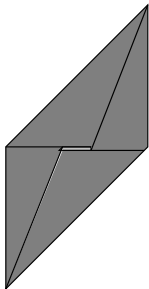

Tuck upper left corner under flap on opposite side and repeat for lower right corner

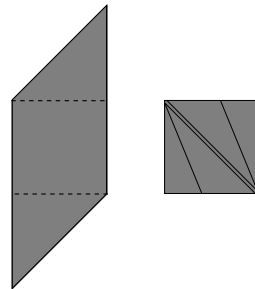

Turn the paper over, crease along dashed lines as shown to complete the module

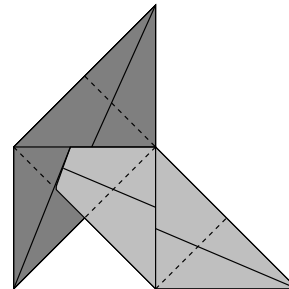

Corners of one module fit into pockets of another

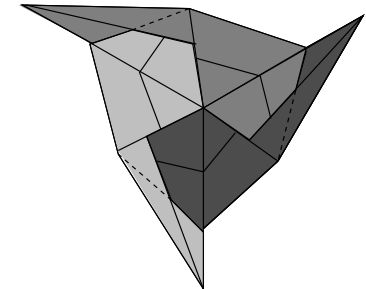

A cube requires six modules
Sonobe modules also make many other polyhedra